

Wall Mounted Touch Panel

Model No.: T1, T2, T3, T4

1-4 color/Glass panel/Touch color wheel/DC input/4 channel constant voltage PWM output/Wireless remote control



CE RoHS EMC LVD

Features

- Touch panel single color, dual color, RGB or RGBW PWM constant voltage controller.
- Ultra sensitive high strength glass touch panel with touch color wheel in the middle.
- Compatibility with RF 2.4G single zone or multiple zone remote control.
- Touch keys with LED indicator.
- White & Black glass panel available.

Technical Parameters

Input and Output				
Model	T1	T2	T3	T4
Input voltage	12-24VDC	12-24VDC	12-24VDC	12-24VDC
Input current	12.5A	12.5A	12.5A	12.5A
Output voltage	4 x (12-24)VDC	4 x (12-24)VDC	3 x (12-24)VDC	4 x (12-24)VDC
Output current	4CH,3A/CH	4CH,3A/CH	3CH,4A/CH	4CH,3A/CH
Output power	144-288W	144-288W	144-288W	144-288W
Output type	Constant voltage	Constant voltage	Constant voltage	Constant voltage
PWM frequency	2000Hz	2000Hz	1000Hz	1000Hz
Light type	Single color	Dual color	RGB	RGBW

Safety and EMC

EMC standard (EMC)	ETSI EN 301 489-1 V2.2.3 ETSI EN 301 489-17 V3.2.4
Safety standard(LVD)	EN 62368-1:2020+A11:2020
Radio Equipment(RED) Certification	ETSI EN 300 328 V2.2.2 CE,EMC,LVD,RED

Weight

Net weight	0.118kg
Gross weight	0.230kg

Environment

Operation temperature	Ta: -30°C ~ +55°C
Case temperature (Max.)	Tc: +85°C
IP rating	IP20

Warranty and Protection

Warranty	5 years
Protection	Reverse polarity Over heat Short circuit

Key function

• T1 Single color panel

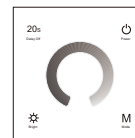

- Power — Turn on/off light.
- Color wheel — Brightness wheel.
- Star — Brightness, 10 levels.
- 20s — Turn off light after 20s.
- M — Dynamic mode, 6 level speed.

• T2 Dual color panel



- Power — Turn on/off light.
- Star — Brightness +, 10 levels.
- Star — Brightness -, 10 levels.
- Color wheel — Color temperature wheel.
- M — Dynamic mode, 6 level speed.

• T3 RGB panel



- Power — Turn on/off light.
- Color wheel — Color wheel.
- Star — Brightness, 10 levels.
- Dynamic mode — Adjust dynamic mode speed, 10 levels.
- M — Short press play 10 built-in dynamic mode, long press 2s run mode-cycle.

• T4 RGBW panel



- Power — Turn on/off light.
- Color wheel — Color wheel.
- Dynamic mode — Adjust dynamic mode speed or static color brightness, 10 levels.
- M — Short press play 10 built-in dynamic mode, long press 2s run mode-cycle.
- 1 2 3 4 — 4 Scenes, short press recall scene, long press 2s to save the current color into 1/2/3/4.
- R G B W — Short press get red, green, blue, white color, long press adjust each color brightness.

Turn on key tone: Long press power key for 5s when light is off, will turn on or turn off key tone.

Wiring diagram

• T1 Single color panel

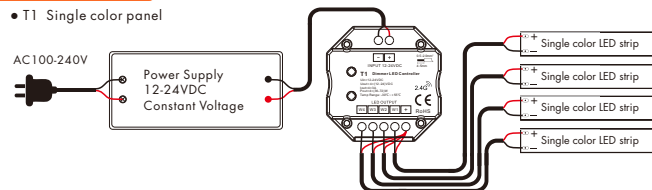

• T2 Dual color panel

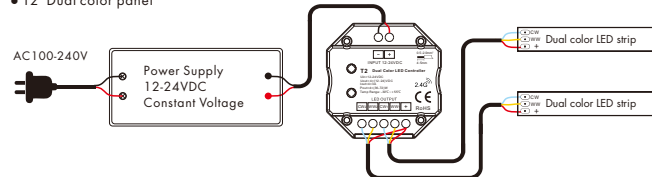

• T3 RGB panel

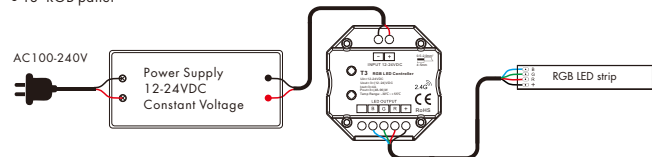

• T4 RGBW panel

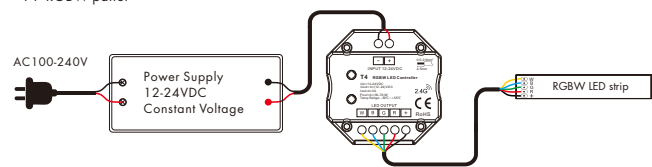

LED power supply voltage and power select :

- 12V lamp, Input 12V power supply, can load 0~144W,
- 24V lamp, Input 24V power supply, can load 0~288W, The power supply power must larger than load power 20%.

Match Remote Control (two match ways)

The touch panel controller can also match with the RF remote (optional).

End user can choose the suitable match/delete ways. Two options are offered for selection:

Use On/Off key

Match:

Turn on light, turn off, immediately press the On/Off key of the panel for 5s, then press on/off key (single zone remote) or zone key (multiple zone remote) of the RF remote within 5s.

The LED indicator fast flash 3 times means match is successful.

Delete:

Turn on light, turn off, immediately press the On/Off key of the panel for 10s, delete all matched RF remote. The LED indicator fast flash 6 times means all matched remotes were deleted.

Use Power Restart

Match:

Switch off the power, then switch on power, repeat again, immediately short press on/off key (single zone remote) or zone key (multiple zone remote) 3 times on the remote. The light blinks 3 times means match is successful.

Delete:

Switch off the power, then switch on power, repeat again, immediately short press on/off key (single zone remote) or zone key (multiple zone remote) 5 times on the remote. The light blinks 5 times means all matched remotes were deleted.

RGB/RGBW dynamic mode list (only for T3 / T4)

No.	Name	No.	Name
1	RGB jump	6	RGB fade in and out
2	RGB smooth	7	Red fade in and out
3	6 color jump	8	Green fade in and out
4	6 color smooth	9	Blue fade in and out
5	Yellow cyan purple smooth	10	White fade in and out

Mechanical Structures and Installations

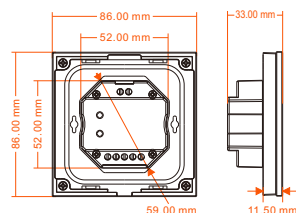

Typical base as below:

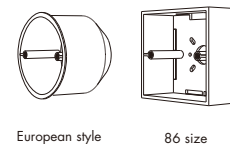

Installation diagram:

